

## Quick Exhaust Valves

### Description

AQ - 02 - NF - E60 - 0202 - P  
V65

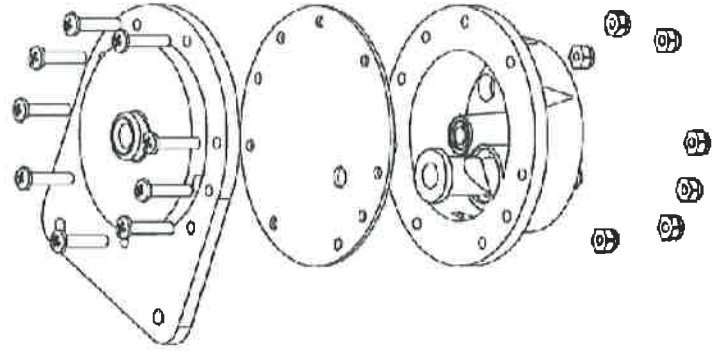

Richway's quick exhaust valve (QEV) helps maintain a positive barrier between the control air supply and the exhaust air from the controlled component. Fast air removal action increases system efficiency and speeds.

A QEV installed in the airline between the actuation control valve and pinch valve can improve valve opening response time. It especially improves if there is a considerable distance between the two components.

The QEV valve body is molded of polypropylene, with choice of rubber diaphragm and duckbill elements.

All ports 1/4" NPT.

NOTE: It is the responsibility of the user to determine suitability of sleeve material for any particular control application.

# Quick Exhaust Valves

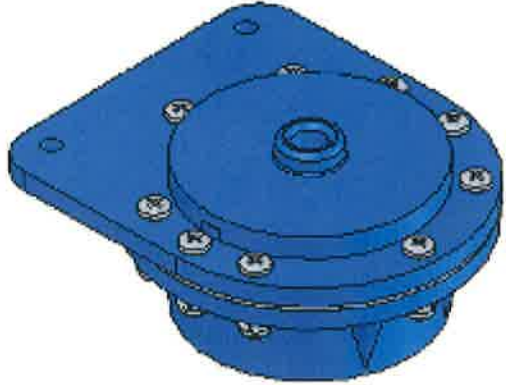

Part #	Price	Description
AP-6199	\$45.00	AQ-02-NF-E60-0202-N
AP-6197	\$45.00	AQ-02-NF-E60-0202-P
AP-6200	\$80.00	AQ-02-NF-V65-0202-N
AP-6198	\$80.00	AQ-02-NF-V65-0202-P
AP-6431	\$30.00	AQ-B-02-N
AP-6201	\$30.00	AQ-B-02-P
AP-6202	\$9.50	AQ-D-02-NF-E60 diaphragm
AP-6792	\$11.00	AQ-D-02-NF-N60 diaphragm
AP-6203	\$33.00	AQ-D-02-NF-V65 diaphragm
AP-6204	\$8.50	AQ-02-BOLT SET